

Preference of Professionals

CamBox[®]
SAFIR S-600

CamBox Safir S600 HQ Junction



Safir S600 PRO



Safir S600 PRO
Plus Set



Flexible Plug Liquid Barrier



TECHNICAL DETAILS

- + High Quality Junction Box
- + Material: Engineering Plastic
- + Safir S-600 is used Instalation Base118 mm diameters.
- + Weight: 170-188 gr
- + Diemension :134x134x61,50mm

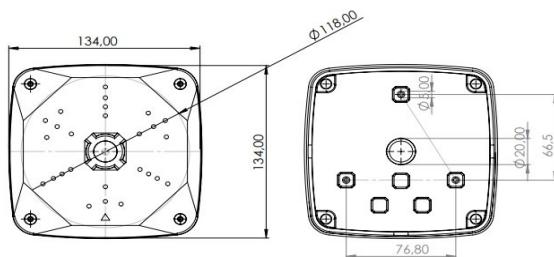

| SAFIR S600 | | |
|--------------------------|-----|----------|
| Differences | PRO | PRO+PLUS |
| FRONT CABLE SEALING PLUG | | X |
| REAR CABLE SEALED GLAND | | X |
| Stainless Screw Set | | X |
| Spirit level | | X |

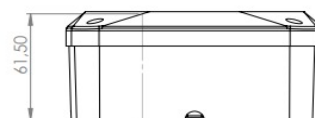

PRO

EAN CODE: 3743114152246

PRO+SET

EAN CODE: 3743114152247

Suitable With All CamBox Accesories